

# Guide Sets & Mold Counters

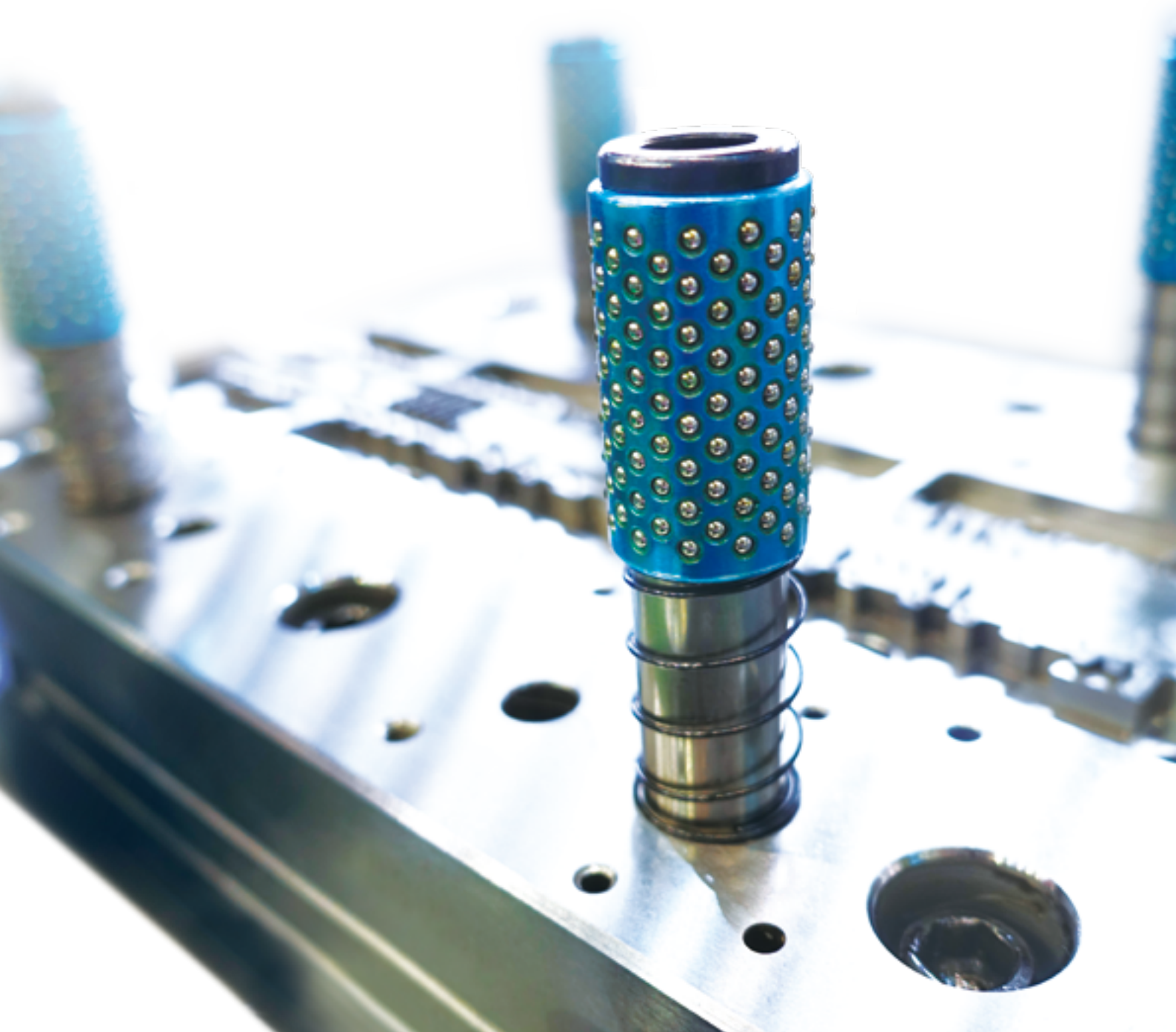

Made in Taiwan

# Guide Sets

For your press molds  
Gaurantee your molds working  
in high precision and high speed



35 years OEM experience  
since 1978

$\pm 0.5\mu\text{m}$  tolerance control ability  
for guide post and bushes

ISO 9001 certified

Customized and small quantity  
production available

# For Press Molds

## AMS PMS

Aluminum ball retainers  
POM ball retainers

Retainer Material : AMS Aluminum  
PMS POM

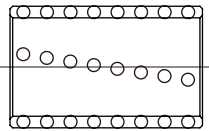

Type	PD	L						D2	d		
AMS PMS	19	60						24.4	3.0		
	20	50	60					25.4			
	22	50	60					27.4			
	25	50	60	75				30.4	4.0		
	28			75				35.4			
	30			60	75			90		37.4	
	32			60					90	39.4	
	36						80	90	43.4	5.0	
	38			70					90		47.4
	40							90	49.4		
	45							90	110	54.4	
	50							90	110	59.4	
60							90	100	110	69.4	

## ACS PCS

Aluminum ball retainers  
POM ball retainers

Retainer Material : ACS Aluminum  
PCS POM

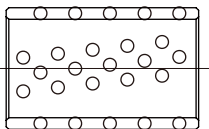

Type	PD	L						D2	d		
ACS PCS	19	50 60						24.4	3.0		
	20	30	35	40	45	50	60	25.4			
	22					50	60	27.4			
	25			40	45	50	60	75	30.4	4.0	
	28						60	75	33.4		
	32						60	75	90		39.4
	38						70	85	90	47.4	5.0
	45							75	110	54.4	
	50								90	110	
	60								100	110	69.4

## LDA LDO

Aluminum ball retainers  
POM ball retainers

Retainer Material : LDA Aluminum  
LDO POM

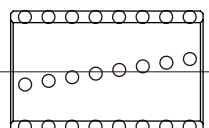

Type	PD	L				D2	d	
LDA LDO	10	25	30	35		13.7	2.0	
	13	25	30	35		16.7		
	16	25	30	35	40	19.7		
	20	25	30	35		25.4	3.0	
	20				40	45		30.4
	25				40	45		30.4

## RDA RDO

Aluminum ball retainers  
POM ball retainers

Retainer Material : RDA Aluminum  
RDO POM

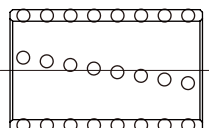

Type	PD	L	D2	d
RDA RDO	19	60	24.4	3.0
	20		25.4	
	22		27.4	
	24	75	29.4	4.0
	25		30.4	
	28		33.4	
	31	85	38.4	5.0
	32		39.4	
	36		43.4	
	37	95	46.4	5.0
	38		47.4	
	40		49.4	
	45		54.4	
	50		59.4	
	56	106	65.4	

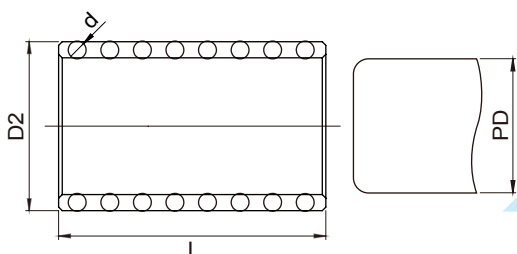

Customized Production is Available

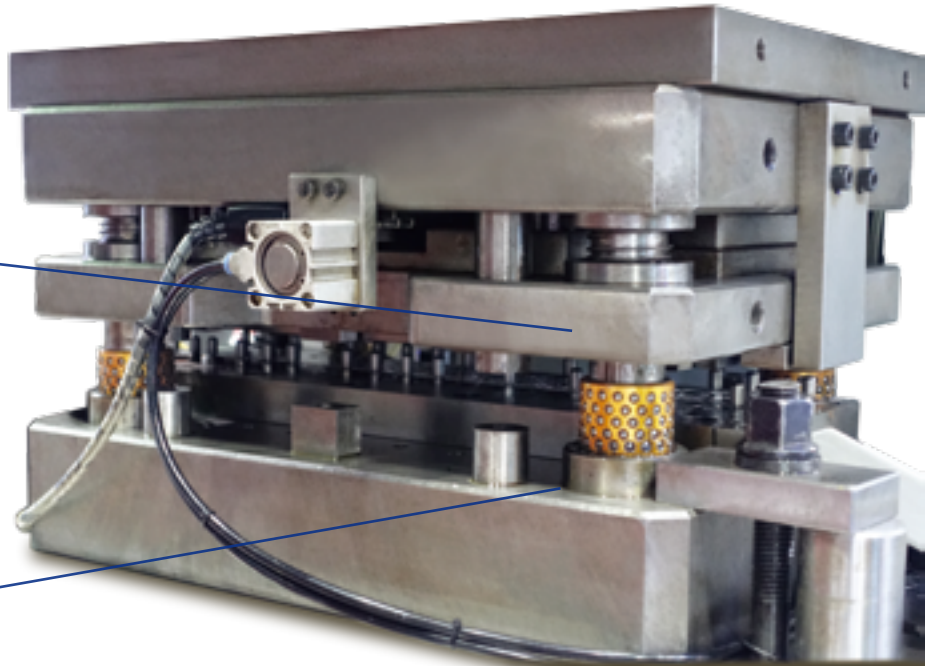

## BA2S BP2S

Double spiral ball retainers

Retainer Material : BA2S Aluminum  
BP2S POM

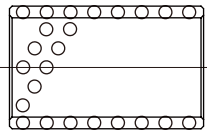

Type	PD	L										D2	d	
BA2S BP2S	10			25	30							13.7	2.0	
	13	15	20	25	30	40						16.7		
	16			25	30	40						19.7		
	19						45	50					24.4	3.0
	20				30	40	45	50					25.4	
	22							50	60				27.4	
	25					40	45	50	60	75			30.4	4.0
	28								60	75			35.4	
	32									75	90		39.4	
	38										90	110	47.4	5.0
	45										90	110	54.4	
	50										90	110	59.4	
	60										90	110	69.4	6.0
	70											120	81.4	
	75											120	86.4	

## BA2T BP2T

Double track ball retainers

Retainer Material : BA2T Aluminum  
BP2T POM

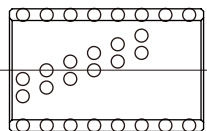

Type	PD	L										D2	d	
BA2T BP2T	10			25	30							13.7	2.0	
	13	15	20	25	30	40						16.7		
	16			25	30	40						19.7		
	19						45	50					24.4	3.0
	20				30	40	45	50					25.4	
	22							50	60				27.4	
	25					40	45	50	60	75			30.4	4.0
	28								60	75			35.4	
	32									75	90		39.4	
	38										90	110	47.4	5.0
	45										90	110	54.4	
	50										90	110	59.4	
	60										90	110	69.4	6.0
	70											120	81.4	
	75											120	86.4	

# 7611

Aluminum ball retainers with anti-dust unit

Retainer Material : Aluminum

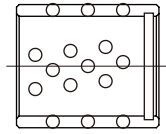

Type	PD	L														D2	d																	
7611	12	20		28		36			42						51										15.7	2.0								
	15					35			42						52											20.4								
	16		24		30	35	37	39	42	47					52												21.4							
	19					35	37			43	47	50			57	65										82		24.4						
	20					35	37			43	50				56	57										72	82		25.4	3.0				
	24									43	50					60	67	77								84	100	108		29.4				
	25									43						52											60	67	77	84	100	108		30.4

Type	PD	L														D2	d																			
7611	30	52			65	74	80																										37.4			
	32	52			65	74	80				90	100																						39.4		
	38			60							85	100																						45.4		
	40		55	60	65			75	80		85		100		115												125	134			150			47.4	4.0	
	48					67			82			94	100	110													125		136					55.4		
	50					67			82			94	100	110													125		136	147				59.4		
	63															100																155	167		70.4	

# 7631

Brass ball retainers with circuit clip

Retainer Material : Brass

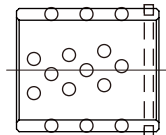

Type	PD	L														D2	d																			
7631	12	20		28		36	42								51																		15.7	2.0		
	15		24		35										52																			20.4		
	16		24		35		42								52													65	72					21.4		
	19				35				43	50					57	65																			24.4	
	20				35					50					57																				25.4	3.0
	24									43					52		60	67	77																29.4	
	25									43					52		60	67	77																30.4	

Type	PD	L														D2	d																				
7631	30		52		65	74	80																											37.4			
	32		52		65	74	80			90	100																								39.4		
	40			60	65		75		85		100		115																						47.4		
	48					67			82			94	100	110														125		136					55.4	4.0	
	50	50				67			82			94	100	110														125		136	147				58.4		
	63																											125						155	167	70.4	

# BA2SR

Double spiral aluminum ball retainers with anti-dust unit

Retainer Material : Aluminum

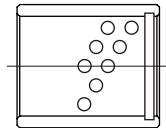

Type	PD	L														D2	d																				
BA2SR	12	20		28		36									51																			15.7	2.0		
	15					35									52																			20.4			
	16		24	28	30	35	36	37							42	47																			21.4		
	19			28		35	36	37							42	43	47	50																		24.4	3.0
	20					35									38	43	50																		25.4		
	22																																		27.4		

# BC2SR

Double spiral brass ball retainers with anti-dust unit

Retainer Material : Brass

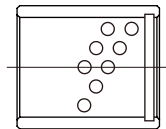

Type	PD	L														D2	d																		
BC2SR	16		20	28																														19.7	2.0
	19																																42	51	
	19																																		24.4

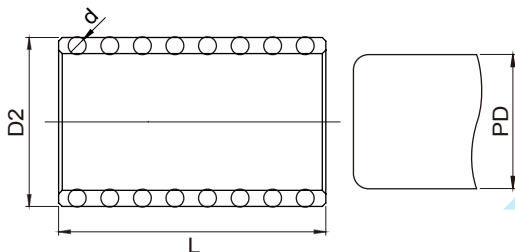

Customized Production is Available

# For Plastic Injection Molds

## EMBSS

Ball retainers

Retainer Material : Brass

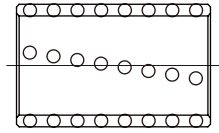

Type	PD	L					D2					d
EMBSS	6						15					1.0
	8	10					15					

## EMBS

Brass ball sliders  
for Ejector Bushings

Retainer Material : Brass

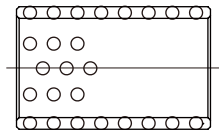

Type	PD	L										D2	d
EMBS	8	25	30	35	40							11.7	2.0
	10	25	30	35	40							13.7	
	13			35	40	45	50	55	60	65	70	16.7	
	16			35	40	45	50	55	60	65	70	19.7	
	20			35	40	45	50	55	60	65	70	23.7	
	25			35	40	45	50	55	60	65	70	28.7	
	30			35	40	45	50	55	60	65	70	33.7	

## EGBTR

Brass ball retainers  
with circuit clip

Retainer Material : Brass

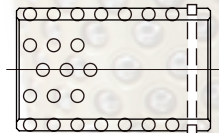

Type	PD	L					D2					d	
EGBTR	10	30		40								13.7	2.0
	13			40			50					16.7	
	16			40			50					19.7	
	20						50		60			25.4	3.0
	25						50		60		70	30.4	

# Machine Tool Components

## WFLK

Brass ball retainers  
for tapping chuck

Retainer Material : Brass

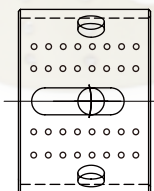

Type	PD	L		D2	d
WFLK-124	24	20		27.3	1.5
WFLK-224	38	36		40.8	
WFLK-324	57	57		60.6	2.0
WFLK-424	72	60		75.6	

# Automation Components

## BGS

### Miniature Brass Ball Sliders

Retainer Material : Brass

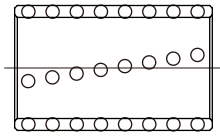

Type	PD	L					D2	d	
BGS	3	10	15		20		4.8	1.0	
	4	10	15		20		5.8		
	5	10	15		20		6.8		
	6		15		20	30	7.8		
	7			17	20		8.8		
	8		15		20	30	9.8		
	10	10			20	30	40		11.8
	12				20	30	40		13.8

## BYS

### Miniature Brass Ball Sliders

Retainer Material : Brass

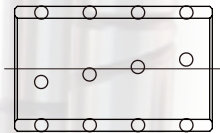

Type	PD	L				D2	d
BYS	2	10	15	20		3.1	0.6
	3	10	15	20		4.1	
	4	10	15	20		5.1	
	5	10	15	20		6.1	
	6		15	20	30	7.1	
	8		15	20	30	9.1	

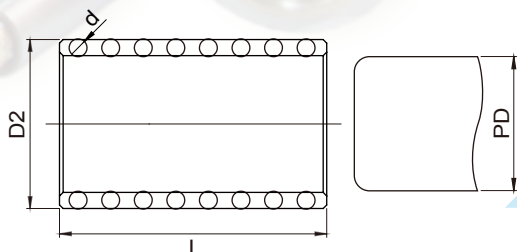
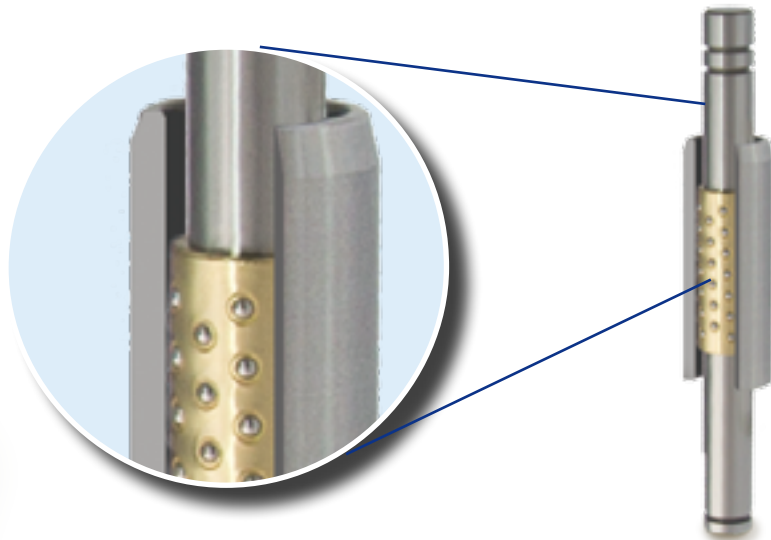

**Customized Production is Available**

# Customized Post & Bush

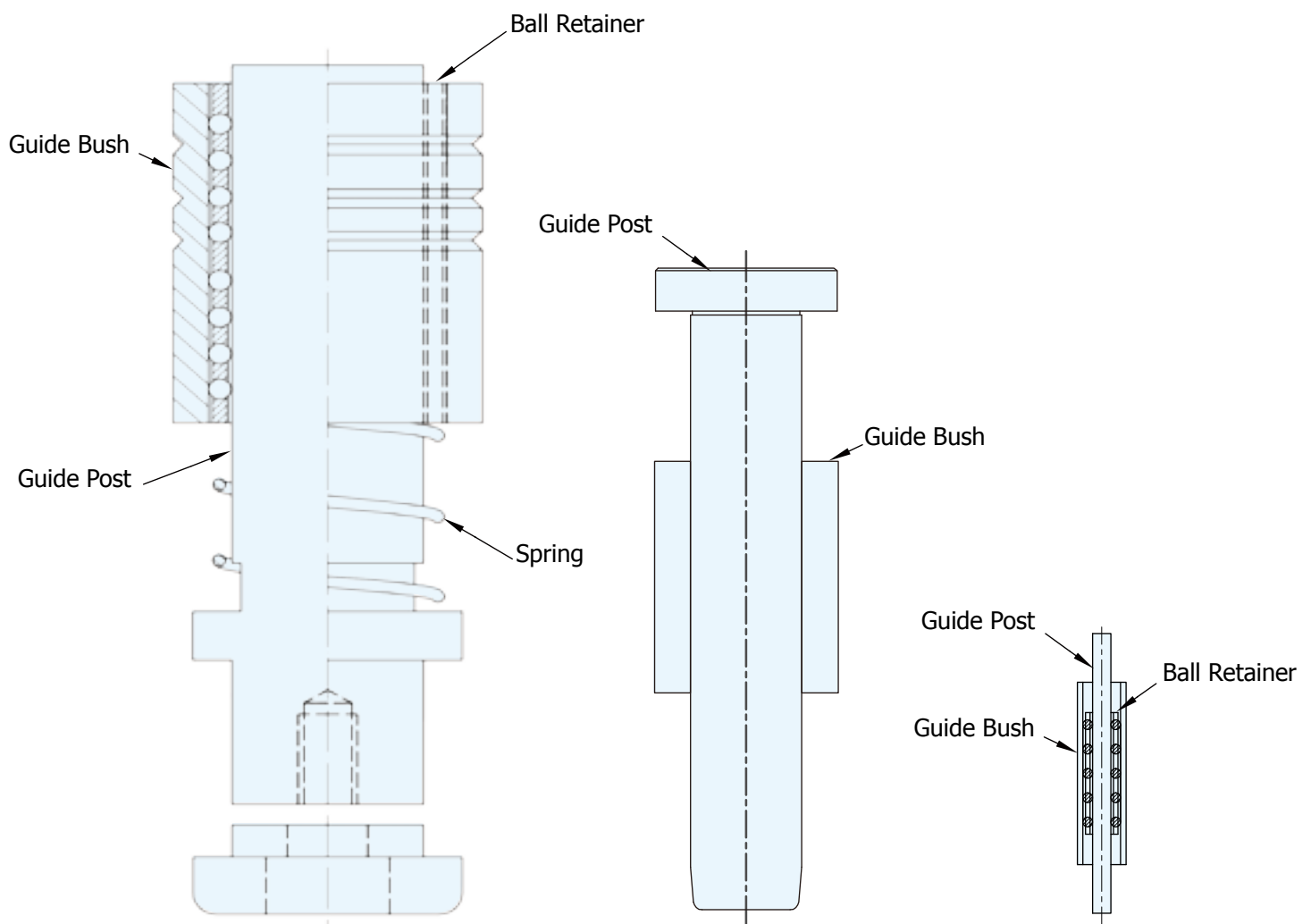

**Customized Production is Available**





**T-sense**<sup>®</sup>  
TSENSE TECHNOLOGY CO.,LTD  
得盛世企業

6F.,No.100,Jian 1st Rd.,Zhonghe Dist.,New Taipei City 235,Taiwan(R.O.C)

TEL:+886-2-77298471 FAX:+886-2-22235743

E-mail:tsense@tsense-tw.com <http://en.toolsetter.tw>